

Plan de amplasament si delimitare a imobilului

Scara 1 : 500

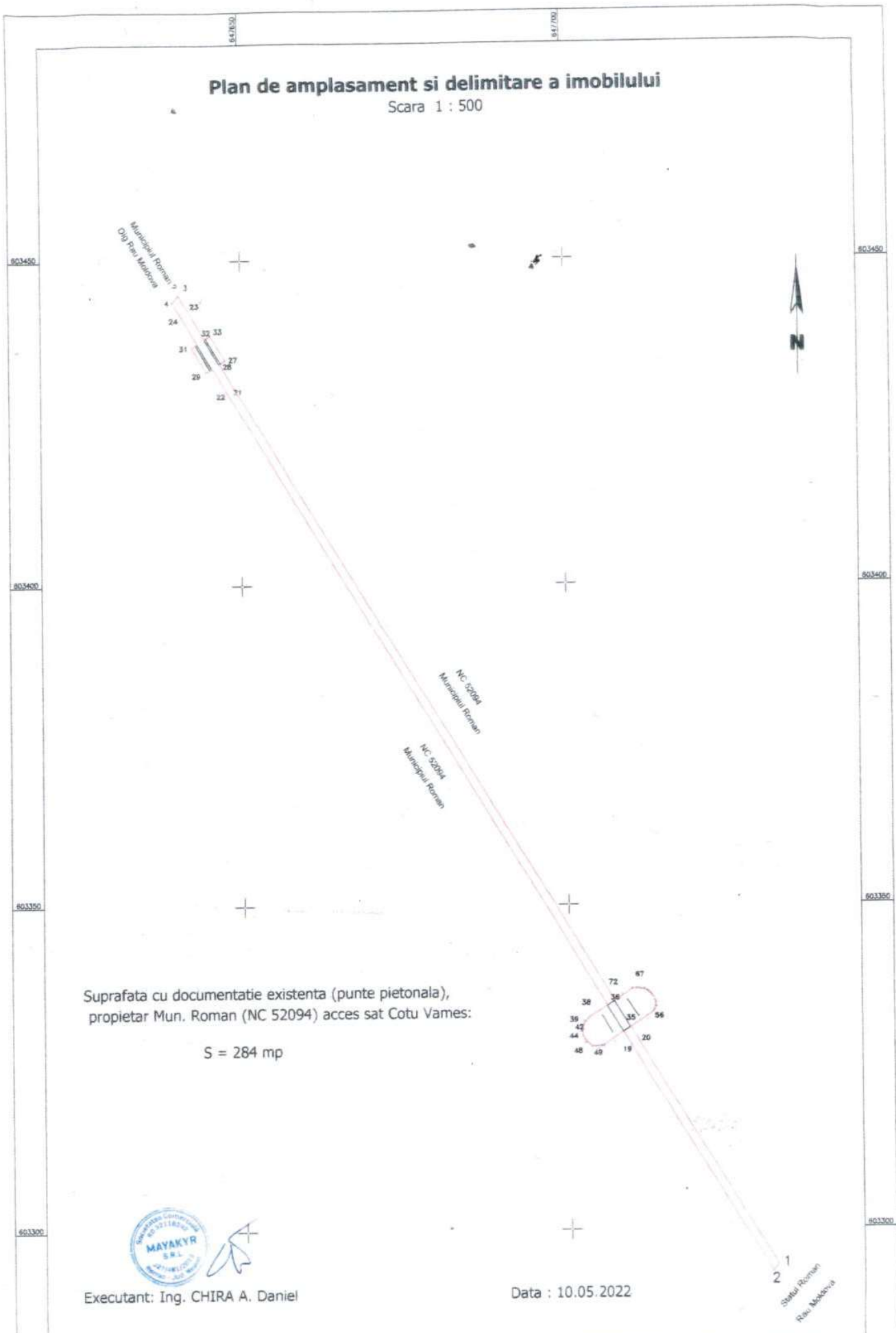

Suprafata cu documentatie existenta (punte pietonala),
proprietar Mun. Roman (NC 52094) acces sat Cotu Vames:

$$S = 284 \text{ mp}$$



Executant: Ing. CHIRA A. Daniel

Data : 10.05.2022

2 1
Statul Roman
Ralu Madahya