

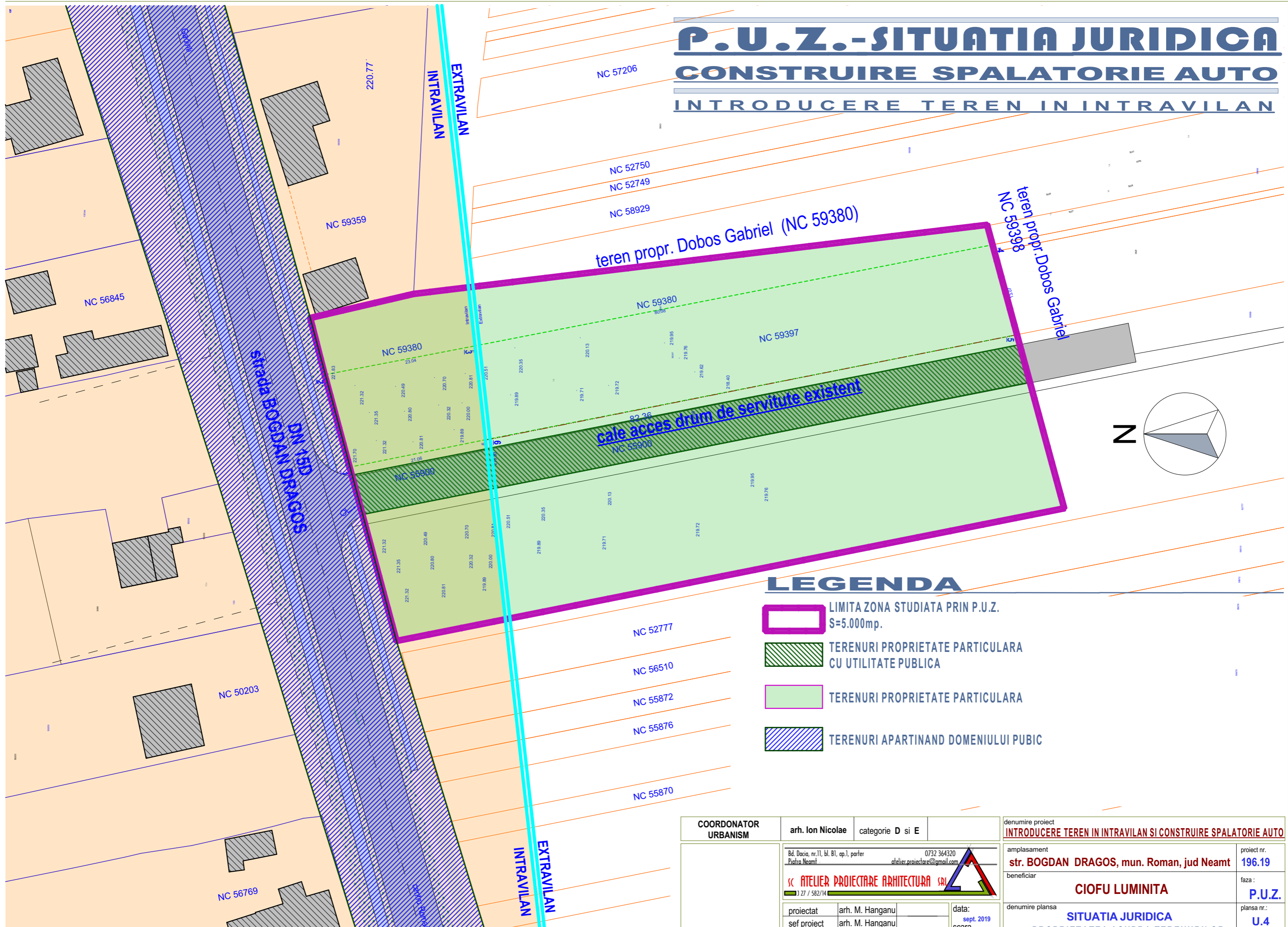

P.U.Z.-SITUATIA JURIDICA CONSTRUIRE SPALATORIE AUTO INTRODUCERE TEREN IN INTRAVILAN



LEGENDA

-  LIMITA ZONA STUDIATA PRIN P.U.Z. S=5.000mp.
-  TERENURI PROPRIETATE PARTICULARA CU UTILITATE PUBLICA
-  TERENURI PROPRIETATE PARTICULARA
-  TERENURI APARTINAND DOMENIULUI PUBIC

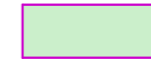
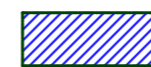
COORDONATOR URBANISM	arh. Ion Nicolae	categorie D si E	denumire proiect INTRODUCERE TEREN IN INTRAVILAN SI CONSTRUIRE SPALATORIE AUTO
	Bd. Dacia, nr.11, bl. B1, ap.1, parter Piatra Neamt 0732 364320 atelier.proiectare@gmail.com		amplasament str. BOGDAN DRAGOS, mun. Roman, jud Neamt
« ATELIER PROIECTARE ARHITECTURA SA » 27 / 582/14			proiect nr. 196.19
proiectat	arh. M. Hanganu	data:	beneficiar CIOFU LUMINITA
sef proiect	arh. M. Hanganu	sept. 2019	faza: P.U.Z.
administrator	arh. Luigi Cimpoi	scara	denumire plansa SITUATIA JURIDICA PROPRIETATEA ASUPRA TERENURILOR
			plansa nr.: U.4