

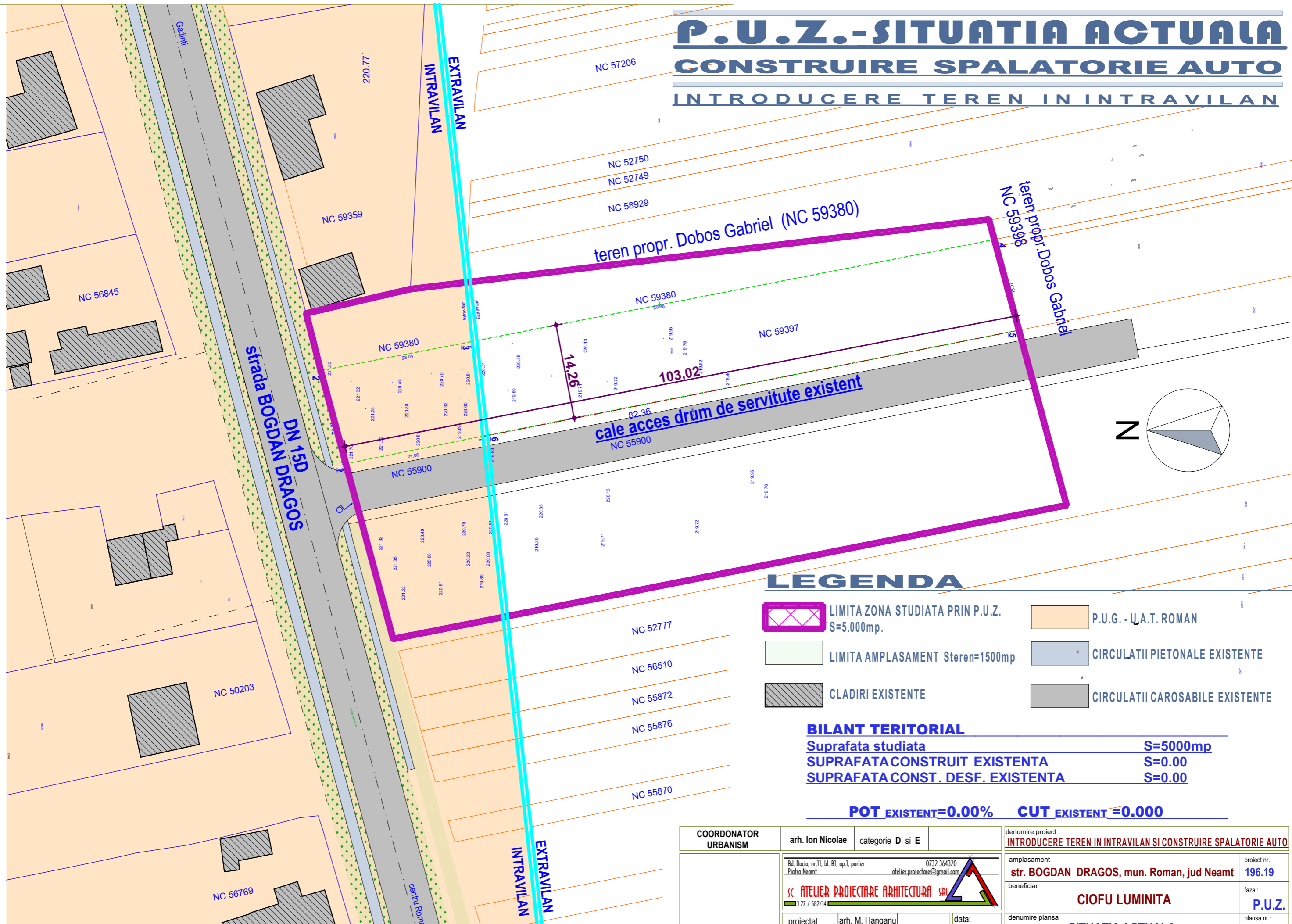



# P.U.Z.-SITUATIA ACTUALA

## CONSTRUIRE SPALATORIE AUTO

### INTRODUCERE TEREN IN INTRAVILAN

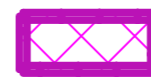
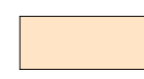

### LEGENDA

-  LIMITA ZONA STUDIATA PRIN P.U.Z. S=5.000mp.
-  P.U.G. - U.A.T. ROMAN
-  LIMITA AMPLASAMENT Steren=1500mp
-  CIRCULATII PIETONALE EXISTENTE
-  CLADIRI EXISTENTE
-  CIRCULATII CAROSABILE EXISTENTE

### BILANT TERITORIAL

Suprafata studiata	S=5000mp
SUPRAFATA CONSTRUIT EXISTENTA	S=0.00
SUPRAFATA CONST. DESF. EXISTENTA	S=0.00

**POT EXISTENT=0.00% CUT EXISTENT =0.000**

COORDONATOR URBANISM	arh. Ion Nicolae	categorie D si E	denumire proiect	<b>INTRODUCERE TEREN IN INTRAVILAN SI CONSTRUIRE SPALATORIE AUTO</b>	
	Bd. Dacia, nr.11, bl. B1, ap.1, parter Piatra Neamt 0732 364320 atelier.proiectare@gmail.com		amplasament	str. BOGDAN DRAGOS, mun. Roman, jud Neamt	
			beneficiar	<b>CIOFU LUMINITA</b>	
proiectat	arh. M. Hanganu	data:	denumire planşa	<b>SITUATIA ACTUALA</b>	
sef proiect	arh. M. Hanganu	sept. 2019			
administrator	arh. Luigi Cimpoi	scara			
				proiect nr.	<b>196.19</b>
				faza:	<b>P.U.Z.</b>
				planşa nr.:	<b>U.3</b>